

reliable vehicle data



BE

Modular Data Interface



What is the BE?

The BE is a modular data processing system for automotive, industrial and climate control. It is designed for creating bespoke solutions and it generates high-quality and reliable data with the help of smart algorithms.

The BE system offers solutions by means of applications. For example: fuel save application, safety application etc. The BE system can operate independently and is not bound by any platform.

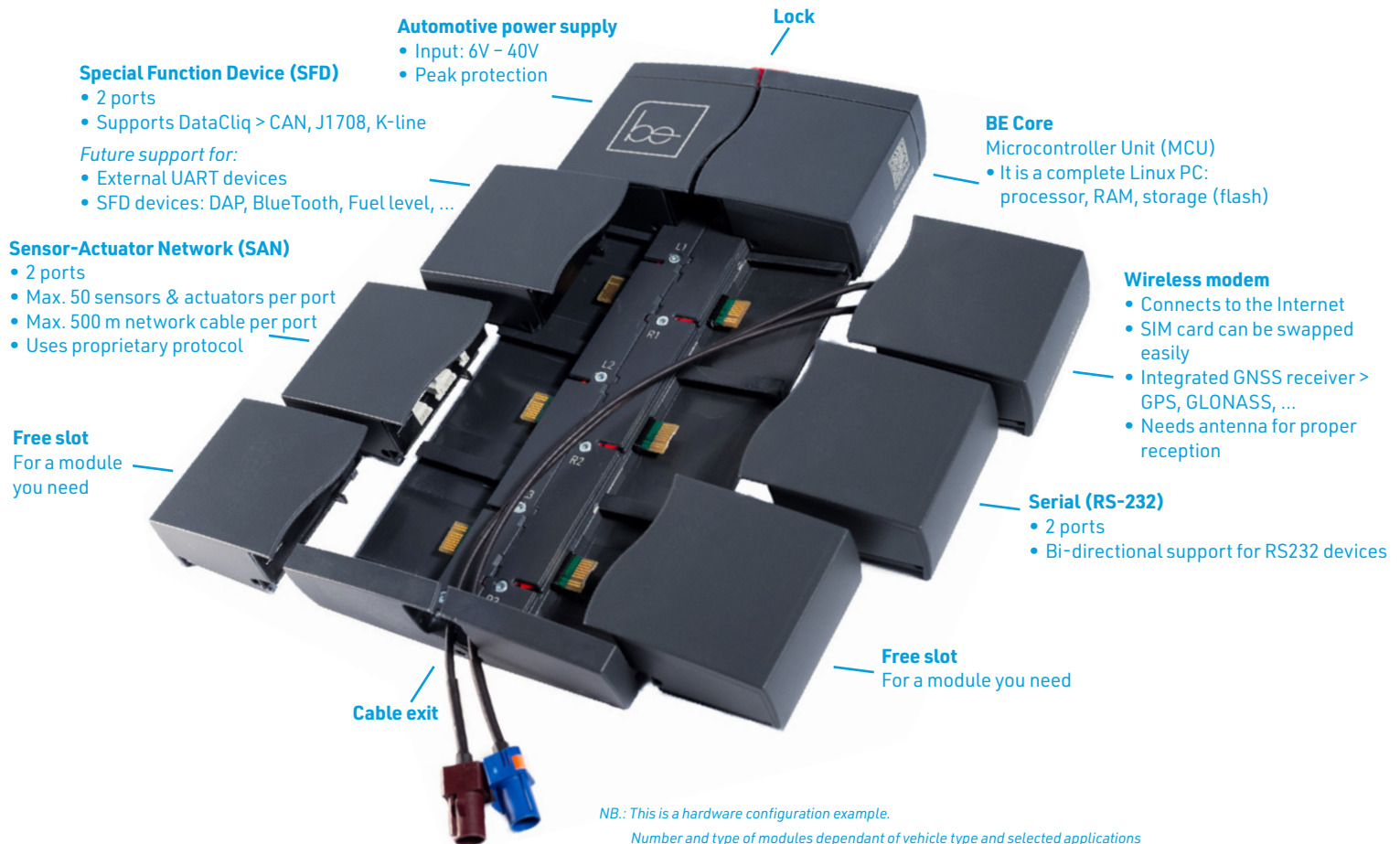

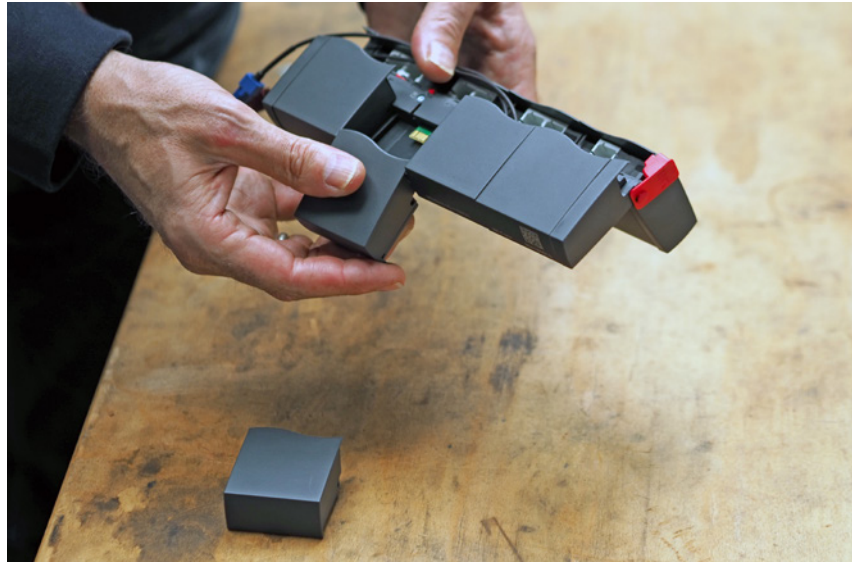
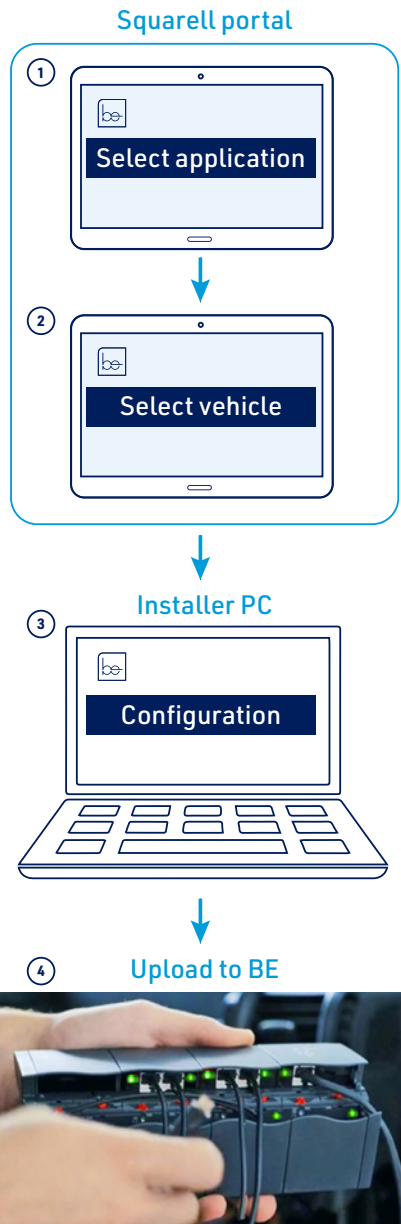

BE modules can have access to:

- Vehicle data & statistics
- Remote diagnostics
- Incident reporter
- Driver behaviour statistics
- Tachograph information
- Battery statistics (electric vehicles)
- Fuel statistics
- A tailor made solution...

The BE's configuration procedure

Available BE modules

POWER	
PSU Automotive	Input: 6V - 40V / Peak protection
MICROCONTROLLER UNIT - MCU	
BE Core	Linux OS
NETWORK	
SFD + SFD	SFD = Special Function Device
SAN + SAN	SAN = Sensor Actuator Network
CAN + CAN	
CAN + K-Line	
CAN + J1708	
RS232 + RS232	
SFD + RS232	
USB + USB	
Ethernet	
Empty	Empty module to fill gaps
MODEM	
Modem LTE-C1+2G EU GNSS	
Modem LTE-M1+2G WW GNSS	

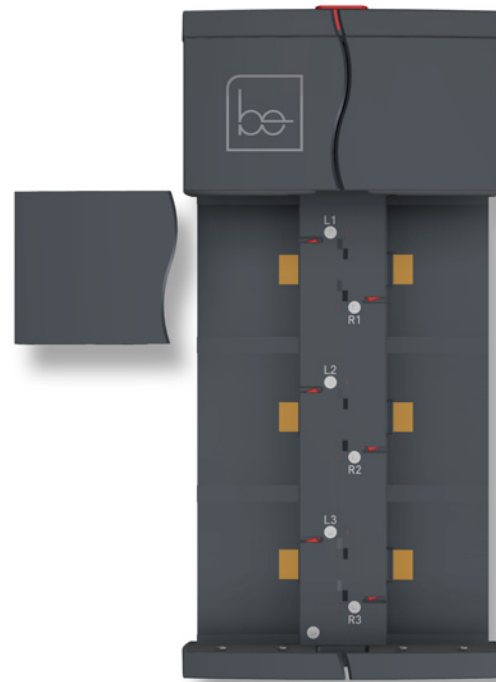

SOLUTIONS

Advanced Tell-tales
Environment
Event Data Recorder
Maintenance
Safety
Tachograph



PRODUCTS

BE
CANcliQ and DatacliQ
Driver Awareness Panel
REMOTE
SOLID



VEHICLES

Buses and Coaches
Electric Vehicles
First Response Vehicles
Trailers
Trucks



INFORMATION

Wired Networks
Wireless Networks



Squarell Technology
Delfweg 48 | 2211 VN Noordwijkerhout | The Netherlands
T +31 (0)252 42 03 11 | E sales@squarell.com | squarell.com



20230126_BE_EK